

HAND OPERATED TWO ROLL SLEEVE WRAPPER



Mod. MA 700 M2

Models

MA 500 M2 – MA 700 M2 – MA 900 M2 – MA 1250 M2

Hand loaded wrapper, with sealer and tunnel mounted on a single steel sheet framework, duly treated and varnished with epossidic powder. The model bears to two rolls (upper and down) which facilitate the “sleeve” closure of the pack.

Operation

Operation of this machine is performed pushing product on inlet table, over sealing bar inside film on adjustable loading station. Sealing is pneumatically driven by push buttons. Load on tunnel conveyor is reached by following packing, film unwinding stations facility “sleeve” closure of packing.

The simple construction of this model allows packing of packs having various shapes and sizes, in relation with production features and size of used film.

Main features

- ▶ Sealing teflon coated hot bar electronically controlled
- ▶ Tunnel electronic thermoregulator controlled air recycling
- ▶ Tunnel conveyor zinc coated mesh, speed 3 mt/min
- ▶ Shrink chamber in steel sheet, studied for a positive heat release of heating electric plugs (embodied in tube and provided with wings) and for a high air flow recirculation, for minimising heat loss.
- ▶ Adjustable air flow with suitable shutters.



Via Puccini, 10 20028 S.Vittore Olona
MILANO - ITALIA
Tel.+39.0331.421658 Fax +39.0331.511434
www.vimacor.it info@vimacor.it

HAND OPERATED TWO ROLL SLEEVE WRAPPER

- ▶ Used film: Flat polyethylene film. Average output: 120/450 pac/hour (purely indicative indication as depend type and dimension of product, consequence of package and type of film used).

Optional

- ▶ Pressing unit for stabilizing goods.
- ▶ Frequency changer (inverter) for adjusting tunnel conveyor speed.
- ▶ Product cooling fan.
- ▶ Synchronised pusher buttons.
- ▶ Bottom motor driven film unwinding station.
- ▶ Photocell for tunnel conveyor continuous or intermittent operation.
- ▶ Film compressing rolls on tunnel outlet.
- ▶ Tunnel conveyor on application in stainless steel, or driven by side chains, or with rods of 10/15 mm diameter lined with rubber, or covered by a Teflon net.
- ▶ Straight or curved Unloading roller truck in different sizes.
- ▶ Double motor driven, top and bottom, film unwinding stations.
- ▶ Tunnel conveyor extended on outlet of 800 mm for stabilising film after shrinking.

	MA 500 M2	MA 700 M2	MA 900 M2	MA 1250 M2
Sealing bar	length 520 x H 320 mm pneumatically operated and push-buttons controlled	length 700 x H 360 mm pneumatically operated and push-buttons controlled	length 900 x H 360 mm pneumatically operated and push-buttons controlled	length 1250 x H 360 mm pneumatically operated and push-buttons controlled
Electrical	3 Ph 220/380 V 6,5 KW	3 Ph 220/380 V 10 KW	3 Ph 220/380 V 13 KW	3 Ph 220/380 V 18 KW
Max reel size	Ø 200 x 480 mm	Ø 200 x 680 mm	Ø 200 x 880 mm	Ø 200 x 1200 mm
Tunnel hood	480 x H 340 x 870 mm length	700 x H 420 x 1150 mm length	900 x H 420 x 1150 mm length	1250 x H 420 x 1300 mm length
Air consumption	6,5 nl./cycle	10,5 nl./cycle	10,5 nl./cycle	16,5 nl./cycle

All data are not engaging



Via Puccini, 10 20028 S.Vittore Olona
 MILANO - ITALIA
 Tel.+39.0331.421658 Fax +39.0331.511434
www.vimacor.it info@vimacor.it

HAND OPERATED TWO ROLL SLEEVE WRAPPER

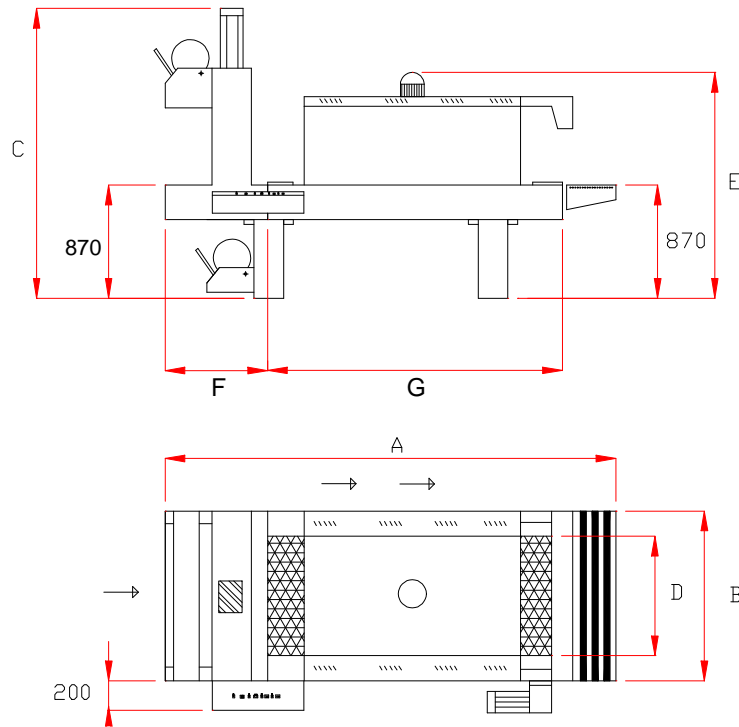

	A	B	C	D	E	F	G	Weight Kg.	Max conveyor load Kg.
MA 500 M2	1950	660	1730	470	1550	400	1250	210	12
MA 700 M2	2510	860	1900	630	1730	600	1610	310	15
MA 900 M2	2510	1060	1900	820	1730	600	1610	470	15
MA 1250 M2	2510	1410	1900	980	1730	600	1610	610	15

Sizes in millimetres – Data not engaging



Via Puccini, 10 20028 S.Vittore Olona
MILANO - ITALIA

Tel.+39.0331.421658 Fax +39.0331.511434

www.vimacor.it info@vimacor.it